

**(A) WATER PUMP STATION**

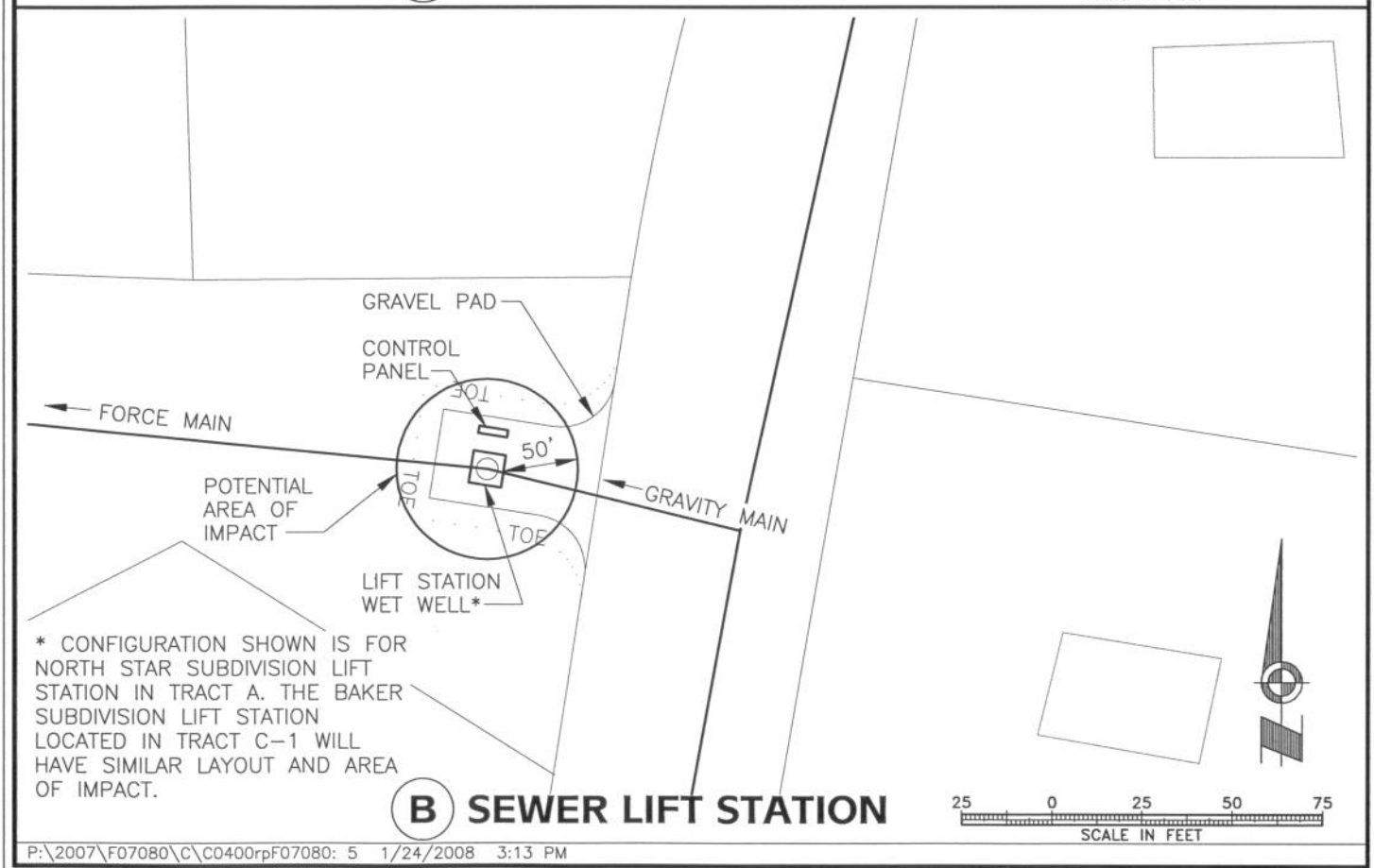

**(B) SEWER LIFT STATION**

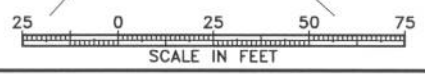
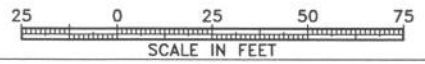

\* CONFIGURATION SHOWN IS FOR NORTH STAR SUBDIVISION LIFT STATION IN TRACT A. THE BAKER SUBDIVISION LIFT STATION LOCATED IN TRACT C-1 WILL HAVE SIMILAR LAYOUT AND AREA OF IMPACT.

P:\2007\F07080\C\C0400rpF07080: 5 1/24/2008 3:13 PM



**BAKER AND NORTH STAR  
SUBDIVISIONS SEWER AND WATER  
PROPOSED PUMP STATION & LIFT STATION DETAILS  
NORTH POLE, ALASKA**

DESIGN: KAB  
DRAWN: GDS  
CHECK: KAB  
JAN 2008

PROJ. No.  
**F07080**  
**5**